

# SURVEYOR'S RECORD

Section 18

Township 107

Range 41

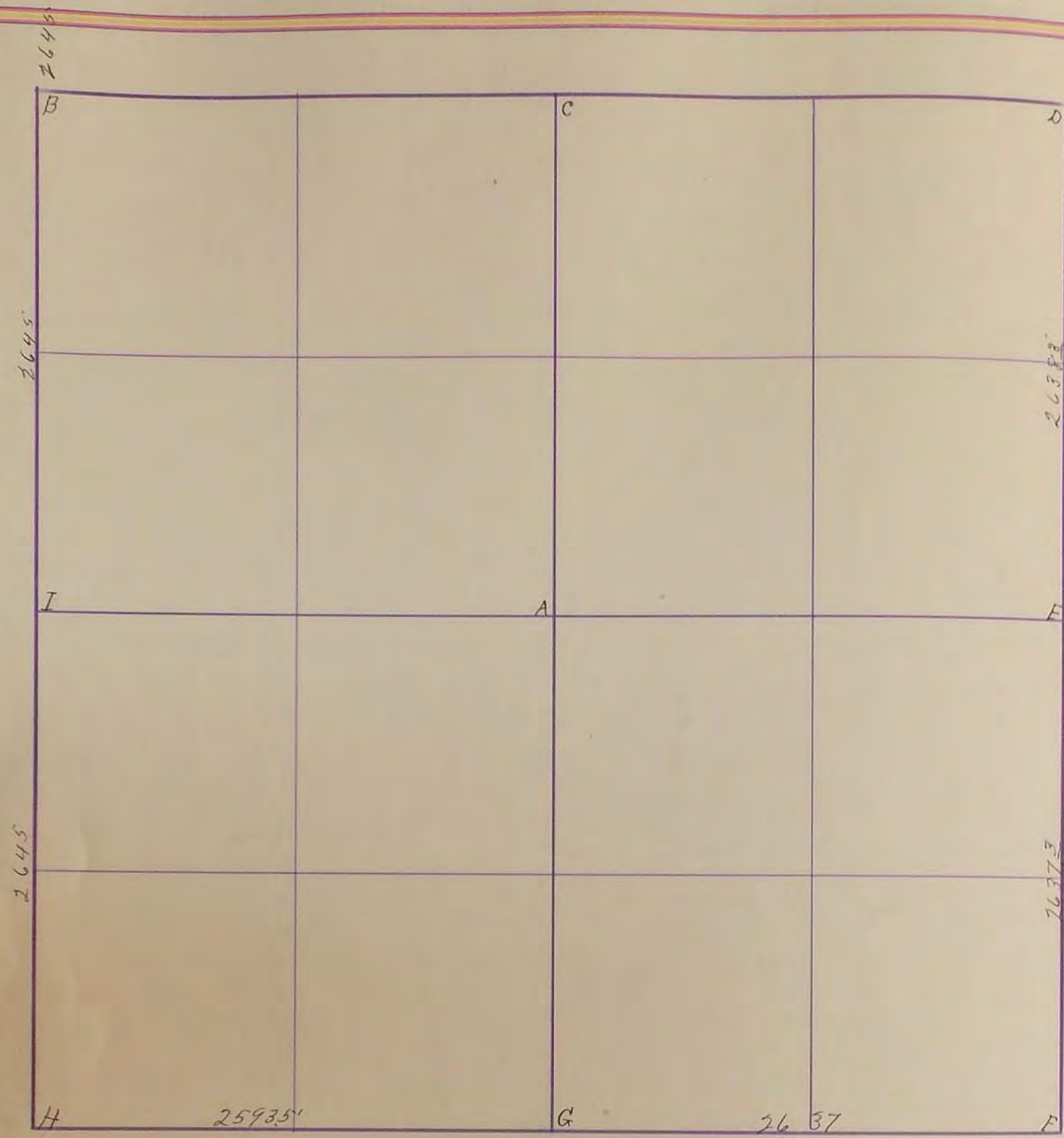

A.

1968

B.

C. Fence post in gov. cor.

D Stone

E stone

F Concrete corners with wire center

G. Stone on Fence line broken tile around stone

H. stone in center crossroads

Old cor. at C, D, F, H.

Established A, E, G - located I by measure but did not line it.

Feb. 7 - 1934

D. Concrete stone: R.P. Jack in fence cor W 36'

R.P. Jack in fence post N.E. 37.4' R.P. Jack in F. cor. E

322

E. concrete stone, R.P. Jack in F. Post E. 344'

R.P. Jack in fence post N.W. 39' - Fence west 13' N of 1/4 stone.

F. Concrete stone R.P. Jack in cor. fence post

N.E. 47.4' R.P. Jack in cor. fence post 47.0' R.P. Jack in

cor. fence post S.W. 47.2' 7.9. March

E. Iron Rod R.P. N+C P.P. SE - 78.00'  
R.P. Nut on Apron NW - 52.40' W - 43.75'

D. Iron Rod R.P. N+C P.P. E - 49.30'  
Top of Steel Post (tile marker)  
NE - 45.30'



SURVEY No. \_\_\_\_\_

Section 16 Town 107 Range 111

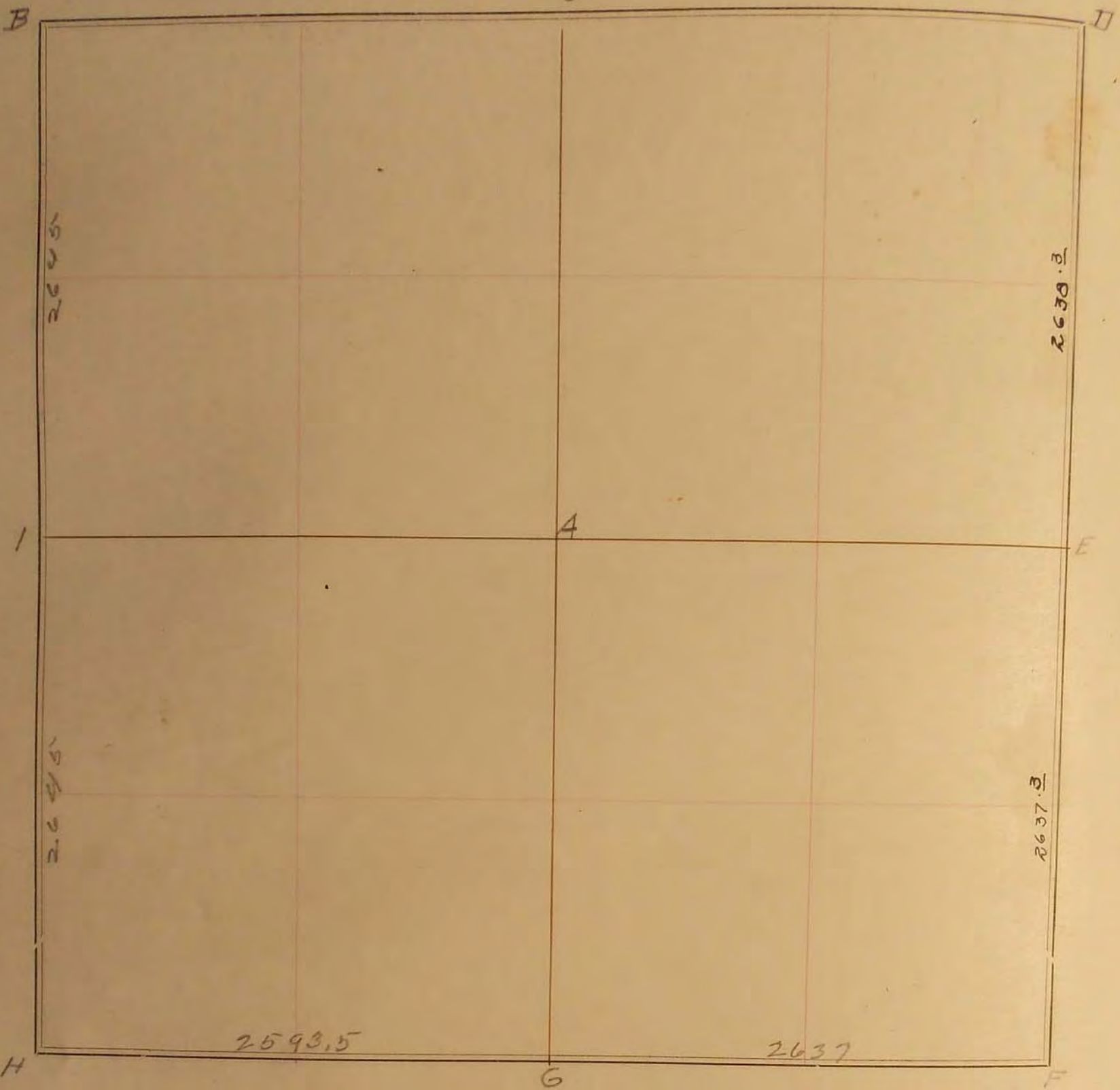

FIELD NOTES.

- A Fence post in gov. corner
- B Stone
- C Stone
- D Concrete corner with wire center.
- E Stone on fence line broken tile around stone
- F Stone in center crossroads
- G
- H
- I

Old cor. at G-D-F-H

Established A-E-G - located I by measure but did not line it

Feb 7, 1934

"D" Concrete Stone R.P. Tack in fence cor West 36' : R.P. Tack in fence post NE 37' : R.P. Tack in fence cor East 32' :

"E" Concrete Stone R.P. Tack in fence post East 34' : R.P. Tack in cor fence post N.W. 39' : Fence west 13' North of 1/4 stone.

"F" Concrete Stone R.P. Tack in cor fence post NE 47' : R.P. Tack in cor fence post 47' : R.P. Tack in cor fence post S.W. 47' :

J. A. March.